

Issue No. 06

Summer 2024

# Waterworks

Made



P. 02

## Introducing Finot

P. 12

Combining Stone  
with Ceramic Tile

P. 14

*Take Note:* Designing  
a Coastal Bath & a  
Clean-Lined Kitchen

P. 18

*The Edit:* Warm Modern  
& Cool Contemporary

# A Modern Trajectory

In this issue of *Waterworks Made*, we're exploring how the realm of contemporary design relates to our ethos as creators. In these stories, we share with you our passion for the blending of product design with best-in-class engineering capabilities required to make our ideas come to life.

We've done this before—for our .25 collection, we invented a new type of valve position that sits below the countertop, yielding minimalist lines that weren't previously possible. We did it for the design of our Formwork faucet, achieving the wide flat spout through meticulous modifications to its mold, and brought that same spirit of innovation to our Bond collection, employing a precise engraving technique that positions the collection as unique and rarified.

Our newest collection, Finot, builds upon this modern trajectory, aiming to exceed what is expected in a contemporary collection. Created in partnership with GACHOT, this endeavor is a true integration of design and engineering expertise. We created refined parts that are

decisively cast and forged to achieve painstaking precision and refinement—techniques rarely seen in commercial production.

The best design exists beyond boundaries. Whether sleek and minimalist or adorned with carefully displayed decorative elements, the right pieces possess a universality that can work in many environments. From the iconic Chesterfield sofa to the Thonet chair and Saarinen table, each exemplifies a versatility that works with diverse architectural styles. At Waterworks, we believe in creating products of enduring quality and adaptability that elevate the spaces they inhabit. Finot, decidedly contemporary, can also move between environments because of its streamlined forms and sleek elegance.

Read on for more of our modern inspirations and find a new favorite of your own. Whatever your vision and wherever your project may be, there's a timeless Waterworks piece that will bring it to creative fruition.

  
Peter Sallick  
CEO & Creative Director

P. 02-11

## Introducing Finot



P. 12-13

## Combining Stone with Ceramic Tile

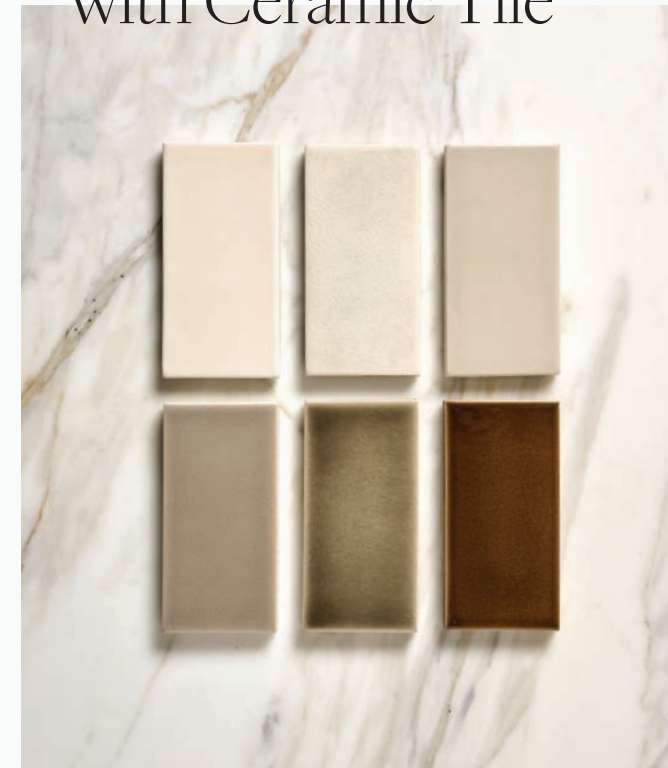

P. 14-17

## Take Note: Designing a Coastal Bath & a Clean-Lined Kitchen

P. 18-21

## The Edit: Warm Modern & Cool Contemporary

P. 22-23

## Welcome Retreats



P. 24-25

## Waterworks Los Angeles



Everything we do at Waterworks is focused on creating an outstanding experience for our clients.

Book an in-person or virtual appointment at any of our 47 locations in 7 countries around

the globe, or contact our direct sales team at 800.899.6757 for assistance. You can also find inspiration and shop online at [waterworks.com](https://www.waterworks.com).

Visit [waterworks.com/locations](https://www.waterworks.com/locations).



# A Contemporary Declaration.

*Introducing Finot*

Finot Lavatory Faucet  
with Lever Handles

IN DARK NICKEL



SLOPE LEVER HANDLES IN DARK NICKEL



WATERWORKS MADE | ISSUE NO. 06

Edited forms. Precise poise.  
Quiet confidence.  
*For the discerning  
contemporary space.*

CROSS HANDLES IN NICKEL



COMING WINTER 2024

Finot Kitchen Faucet  
with Lever Handle

IN NICKEL



PETER SALLICK | WATERWORKS

Tell us about how Finot came to be. What is the background behind the collaboration?

**PETER**

The Gachots have been clients and friends for years. John and Christine [Gachot] consulted on the renovation of our 58th Street showroom and also designed my own apartment in New York. We worked on projects like the Pendry Manhattan West Hotel and Brooklyn Tower. And, after I asked John and Christine to collaborate on the Bond collection in 2020, we've been planning what's next ever since.

**JOHN**

We have a long-standing friendship and partnership with Peter and Waterworks. Our first product collaboration was Bond in 2020, which came out of working together on the design of the Shinola Hotel.

What were the inspirations behind Finot?

**PETER**

I saw a gap in the market for an elevated contemporary collection like Finot, and wanted to do it the Waterworks way. We wanted it to feel like the most flawlessly tailored garment—something where even the slightest adjustment made all the difference to how you feel about it.

**JOHN**

Certainly the fashion comparison fits. It has a sculptural quality in terms of form and minimalist beauty. Christine also compared the Slope Lever Handle to a steak knife, which I think is just perfect. It's thin, elegant, and refined, but also comfortable and substantial in the hand. I love it when the waiter brings that great knife to the table just before my dinner is served. It's a signal of what's to come.

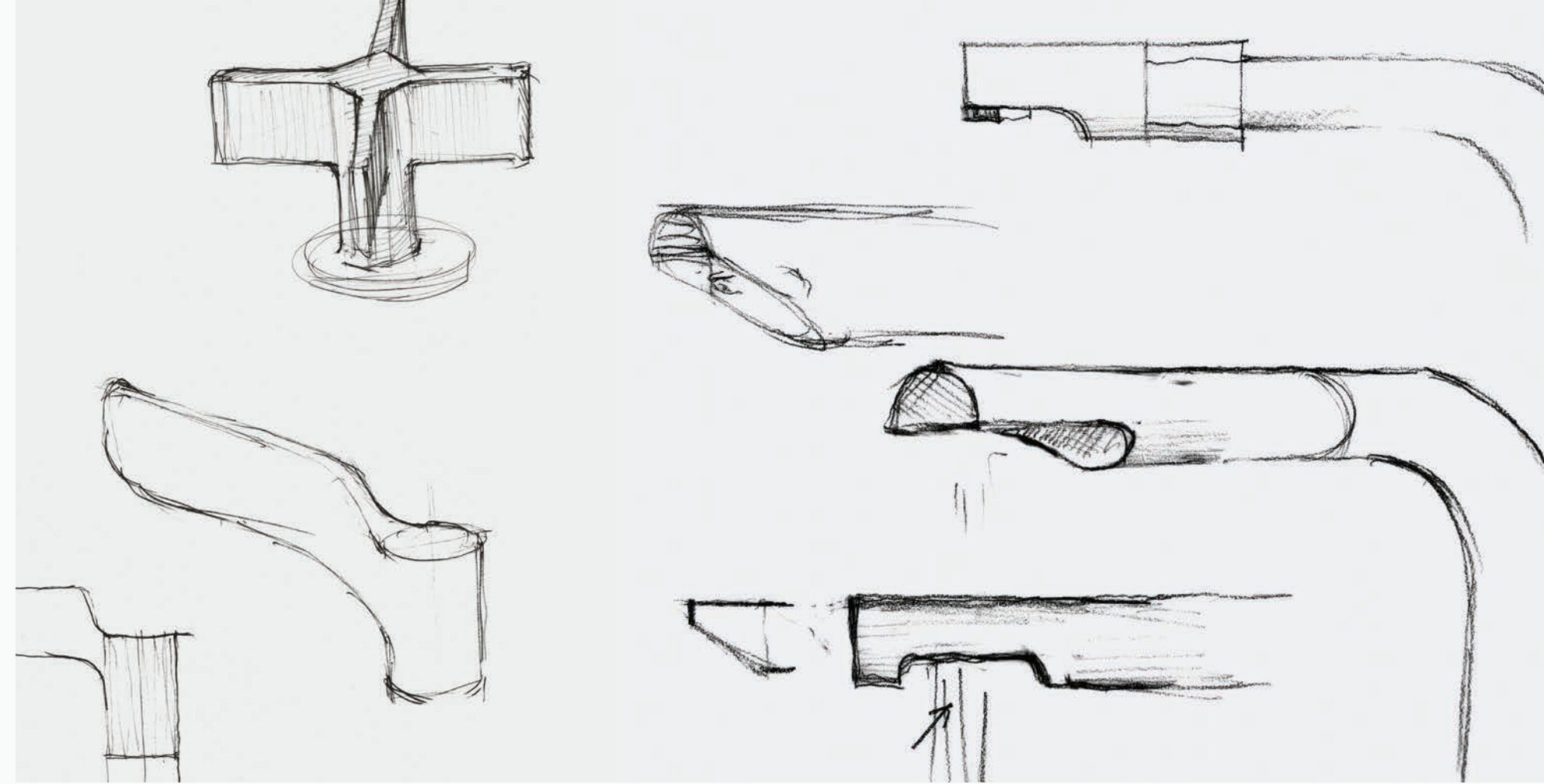

“We wanted it to feel like the most flawlessly tailored garment or the perfect expression of a clean design object—something where even the slightest adjustment made all the difference to how you feel about it.”

– PETER SALLICK

What makes Finot special?

**PETER**

Unlike with transitional pieces, the design isn't highlighted by its ornamental elements—it's about the simplicity of the design itself. Our engineering and manufacturing expertise enabled us to literally forge something unique. It allowed us to focus on the details that others do not, and to play with proportions to create a unique sense of scale... an oversized handle stem paired with elongated and extra-fine handle blades, for instance.

**JOHN**

Finot has a sense of lightness that can transform a space. It has a more sculptural element that makes it

feel almost handcrafted rather than machine-made. This kind of aesthetic is much harder to produce, but when you get it right, it feels incredibly human and distinctive at the same time.

Speaking of production, what was the development process like?

**PETER**

The creation was an intricate process. Most of the components are cast or forged, which enabled us to perfect every painstaking detail. For instance, the spout is one solid cast piece with no seams, making it like a working sculpture. It's a real achievement of design and engineering, and something only Waterworks would do.

**JOHN**

We prototyped many times to get every piece just right, from the spout to the handles, the lighting, and all the accessories. We obsessed over every shape and form, down to the tiniest details. We're not talking just about 16ths of an inch, but down to 32nds and 64ths.

What kind of spaces do you see Finot in?

**PETER**

Even though it's a contemporary, minimalist collection, I see it working almost anywhere. Of course it can work with more contemporary designs, and we love being a part of these kinds of

spaces, but all of our products have a purity and classic understanding of form that allows them to live in a range of spaces. That enables us to support the best designers and projects across the world, with pieces that feel at home everywhere.

**JOHN**

I agree that it can work in any kind of project, contemporary or traditional. Finot would be equally at home in a residential or commercial space, as well. There's a fluidity and balance to every piece in this collection, and it's really designed to make a sleek, light, graceful statement. And that's universal.

“We obsessed over every shape and form, down to the tiniest details. We're not talking just about 16ths of an inch, but down to 32nds and 64ths.”

– JOHN GACHOT

# A conversation with Peter Sallick & GACHOT on Finot.



JOHN AND CHRISTINE GACHOT | GACHOT PHOTOGRAPHER: WILLIAM JESS LAIRD

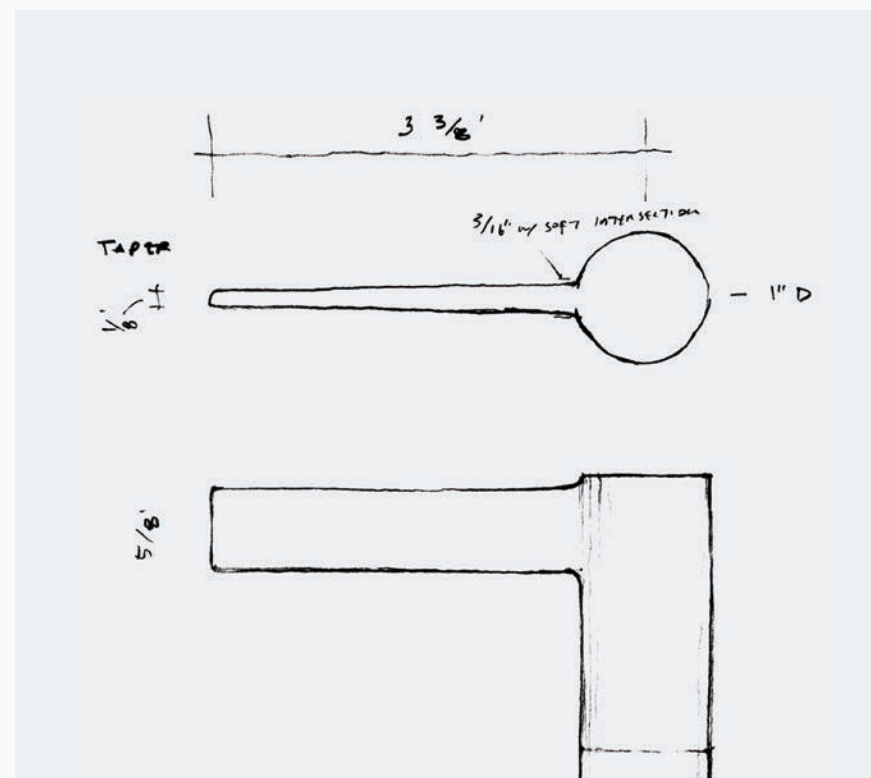



Universal Cube  
Showerhead  
IN NICKEL

Spare forms *and*  
meticulous details  
*render a pure*  
expression.



Finot Volume & Diverter  
Control with Pins  
IN NICKEL



*Astute engineering  
fashions a tailored fluidity  
across the collection.*

Finot Double  
Sconce  
IN BRASS



Finot  
Accessories

LIGHTING, HARDWARE & WALL MOUNTED ACCESSORIES

*Design Schemes We Love*

# Combining Stone *with* Ceramic Tile



Pair our handmade ceramic tiles and stone surfaces for a tried-and-true mix of texture and tone. Whether playing light against dark for visual drama or keeping colors consistent for a sense of unity and airiness, there are many design stories to be told. Integrate them in showers, floors, or walls for a dynamic combination that delights the senses.

**LEFT:**

**ARCHITECTONICS2 GLOSSY TILES:**  
 (Light to Dark): Parchment,  
 Charcoal Crackle Wash, Linus,  
 Vesper, Oat, Cedar

**KEYSTONE SLAB:** Calacatta Honed



**RIGHT:**

**ARCHITECTONICS2 GLOSSY TILES:**  
 (Light to Dark): Whitewash,  
 Sapphire Crackle Wash, Gainsboro,  
 Parker, Gunmetal, Falcon

**KEYSTONE SLAB:** Bardiglio Honed



KEYSTONE IN CIELO HONED

BOND W/ GUILLOCHE LINK KNOB HANDLES

CLARA SINK



COSTINE SCONCE W/ ETCHED GLASS

LUMINAIRE 4CM X 6CM STACKED MOSAIC IN AURORA

OPLUS MIRROR

ALTA CANING DOOR PANELS

6" DASH PULLS

ALTA HALF ROUND BEAD DETAIL

ALTA CABINETS IN CLEAR OAK

ARCOS BATHTUB

GOTHAM COTTON TOWELS



# Take Note: Designing a Coastal Bath

A primary bath grounded by Waterworks Alta Cabinetry in clear oak, with bespoke caning door panels, sets the stage for a wide range of components. Bond faucets complemented by modern accessories and our Arcos bathtub imbues a laid-back, inviting oasis.



MAGMA 2" X 8"  
FIELD TILE IN ZINC

6" PINNACLE  
PULL

FORMWORK GOOSENECK  
W/ KNOB HANDLES

KERR STAINLESS  
STEEL SINK

KEYSTONE IN  
CARRARA POLISHED



ALTA SQUARE  
BEAD DETAIL

ALTA CABINETSRY IN  
ANTIQUUE WALNUT

ALTA RIBBED GLASS  
DOOR PANELS

## Take Note: Designing a Clean-Lined Kitchen

A well-appointed contemporary kitchen shines with our Formwork faucet and cool blue Magma tiles. Waterworks Alta Cabinetry in walnut with square bead details further frames this hardworking, multifaceted culinary retreat.

# The Edit: Warm Modern

The welcoming side of modernism comes together through a harmonious blend of clean lines and contours, weaving a narrative that's both warm and considered.



.25



Bond



1. Opus Mirror 2. .25 Faucet 3. Floe Soap Dish 4. Alta 36" Integrated Vanity  
5. Axil Sconce 6. Bond Towel Bar 7. Bond Tub Filler 8. Alatri Marble Bathtub  
9. Gemma Tile in Chestnut Matte 10. Grano Hand Towels 11. Bond Hook



# *The Edit:* Cool Contemporary

Clean-edged aesthetics softened by rounded forms exude an allure that captivates with understated sophistication.

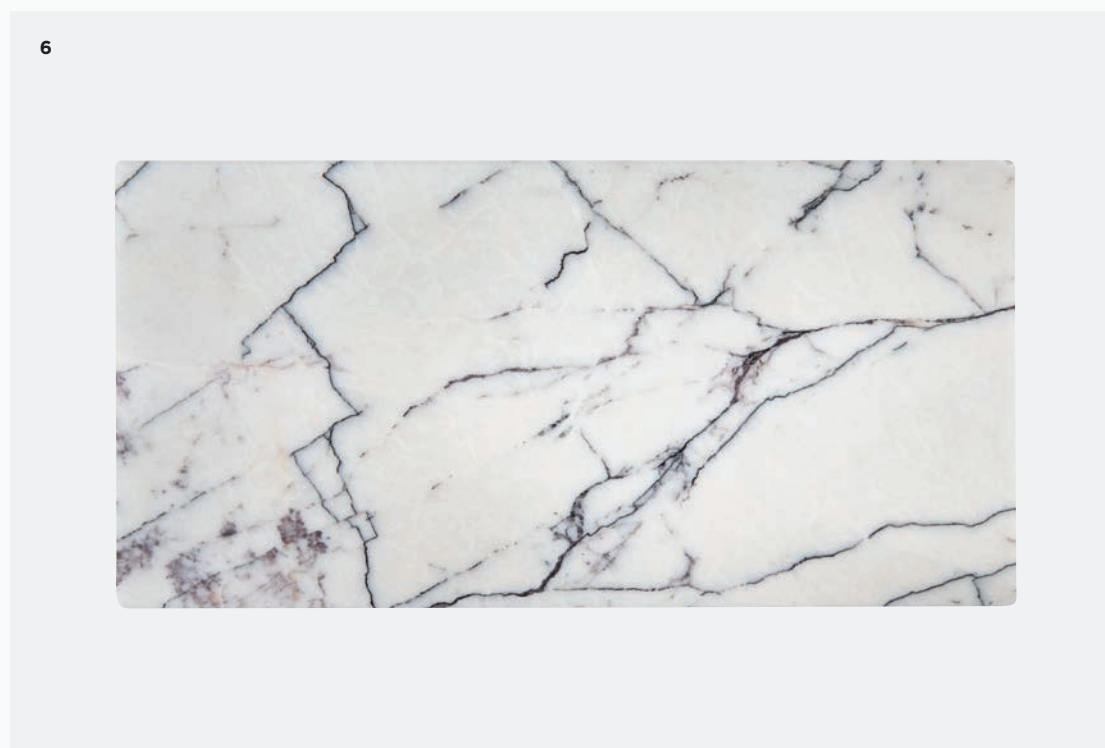
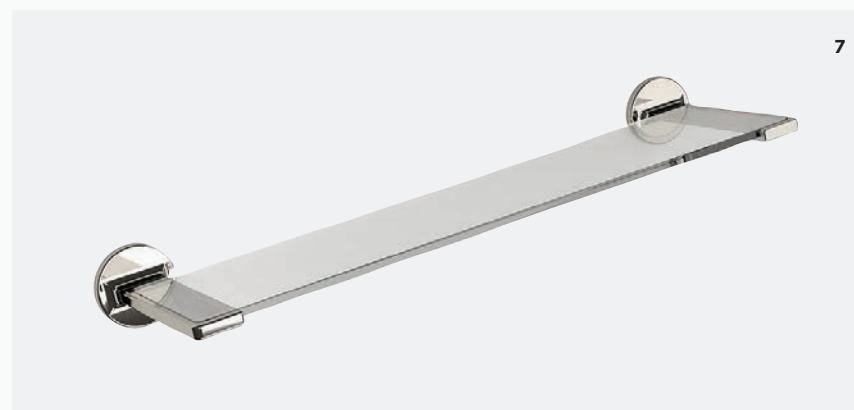
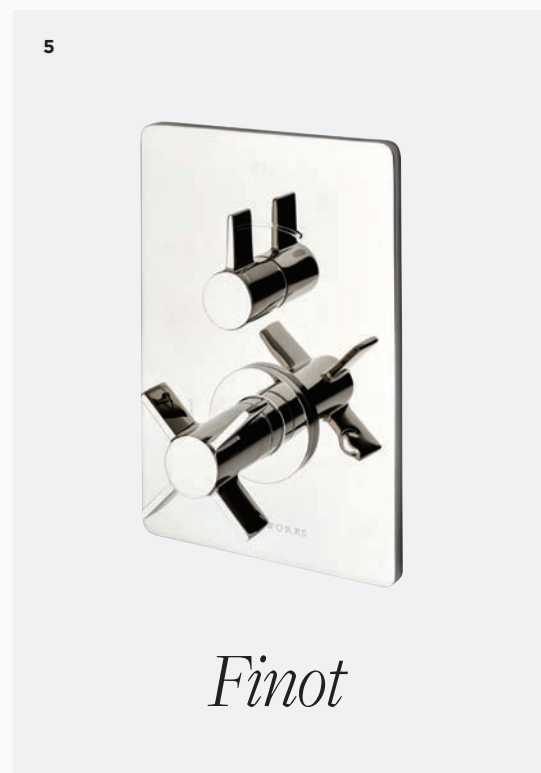

1. Arcata Bathtub 2. Marlon Light 3. Flyte Tub Filler 4. Universal Cube Showerhead  
5. Finot Integrated Thermostatic 6. Keystone in Lilac 7. Formwork Shelf  
8. Universal Shower Drain 9. Opus Washstand 10. Bond Mirror 11. Formwork Faucet



ARCHITECT: OLSON KUNDIG  
DEVELOPER: REPLAY DESTINATIONS



### Canopy Residences at Mill District

HEALDSBURG, CA

In the heart of Healdsburg, these awe-inspiring homes were created by world-renowned architect Olson Kundig and feature two of our modern fittings, Bond and Flyte.



ARCHITECT: EGY ARCHITECTS  
DEVELOPER: HAYMAX  
PHOTOGRAPHER: NICOLE FRANZEN



### MOLLIE Aspen

ASPEN, CO

Drawing inspiration from Japanese and Scandinavian design—as well as Aspen itself—Post Company designed this low-key, calming getaway that features our .25 fittings.

*Hospitality & Multi-Unit Residential*

# Welcome Retreats

With a perfect sense of modernity, these enviable spaces featuring Waterworks feel innovative yet inviting. Step inside some of our favorite new commercial projects.



PHOTOGRAPHER: MIKKEL VANG

### 1 Hotel

HANALEI BAY, HI

This waterfront wellness sanctuary is an enticing escape from the everyday. Nicole Hollis designed the luscious interiors, which include our .25 fittings.

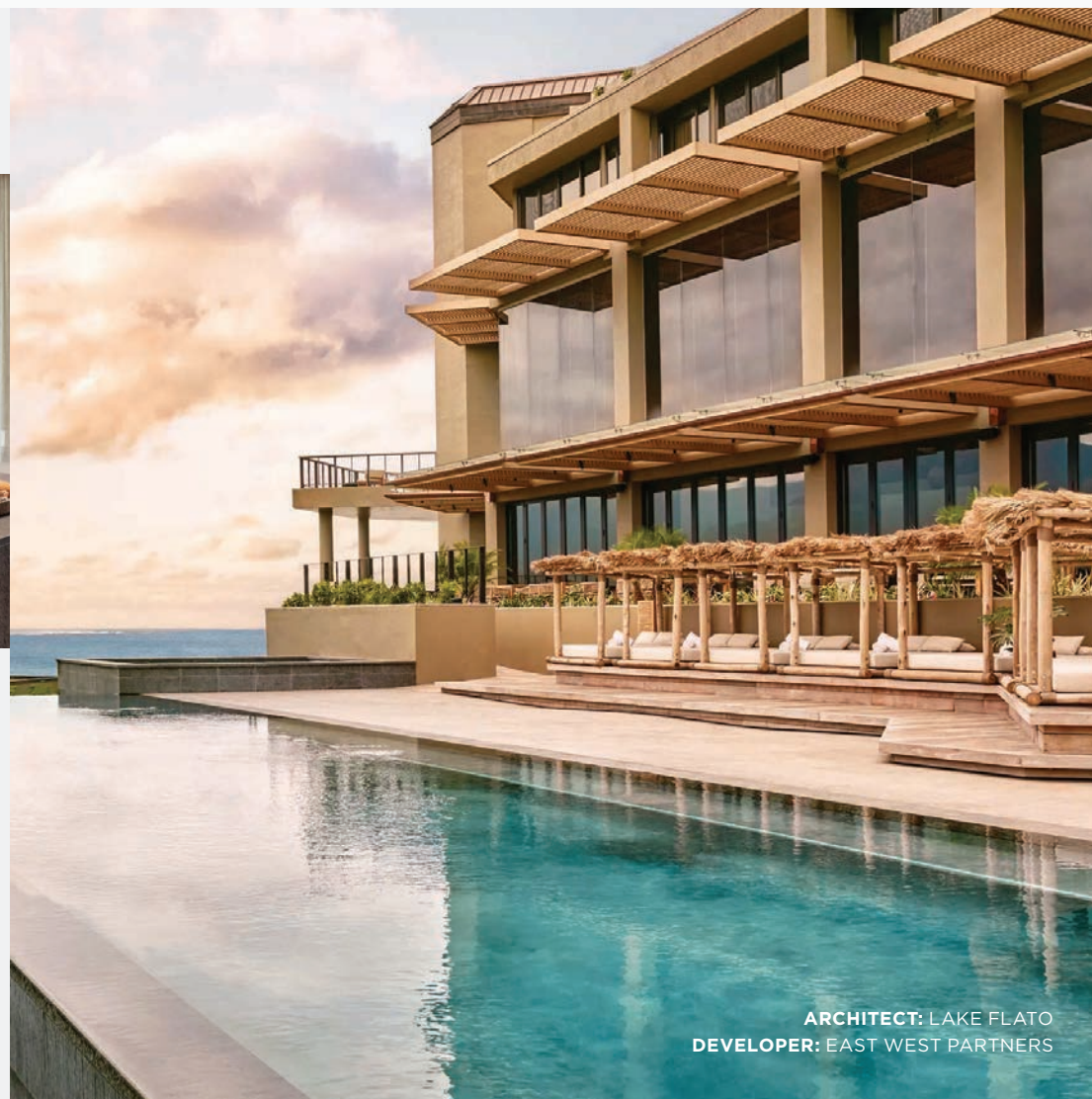

ARCHITECT: LAKE FLATO  
DEVELOPER: EAST WEST PARTNERS



### One Boerum Place

BROOKLYN, NY

An iconic new address in Brooklyn, One Boerum Place was developed and designed by Avery Hall, with interiors designed by Gachot, who also collaborated on our Bond collection, featured in every spectacular unit.



ARCHITECT: SLCE ARCHITECTS  
DEVELOPER: AVERY HALL



*See Us in*  
**Los Angeles**

8431 Melrose Place | Los Angeles, CA

Los Angeles is a city that's always evolving, with a fresh sense of style and design that's all its own. We take its spirit to heart. At our Melrose Place showroom, we have updated fittings, surfaces, and accessories on display, with all-new finds for every type of visitor. See you there.

**When in Los Angeles**

STAY  
 The Pendry  
 EAT  
 Funke

SHOP  
 Obsolete  
 SEE  
 The Broad



WATERWORKS

60 BACKUS AVE  
DANBURY, CT 06810

*Inspiration  
Awaits*

THE WATERWORKS  
PROJECT GALLERY



*Designer M. Elle Design  
Photographer John Merkl*